

Flat Washers - Type A (Narrow) - SAE

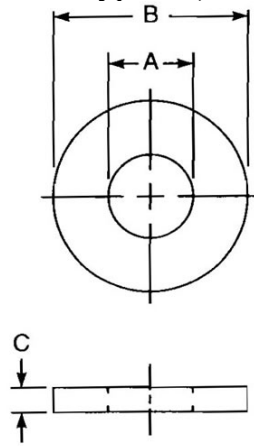

DIMENSIONAL DATA		
Type: Flat Washers - Type A (Narrow) - SAE	Standard: ASME B18.21.1-2009	Size: #10
Nominal: 0.19	A - Inside Diameter: 0.227 - 0.214	B - Outside Diameter: 0.515 - 0.495
C - Thickness: 0.065 - 0.036		
MATERIAL DATA		
Typical Material: Unhardened Carbon steel, 1006	Hardness: no requirement	
FINISH DATA		
Finish Type: Zinc & Clear, non-hexavalent/Cr(VI) free - .0001"/ 3µm	K factor (ref. DIN 946): 0.22	RoHS/REACH Compliant: yes
Min.. Thickness (inches): 0.0001	Min. Thickness (µm): 3	Color: Silver/Gray
White Corrosion (Hours), ref. ASTM B117: 6	Salt Spray, red rust (0 to 99 hrs), ref. ASTM B117: 12	ASTM Standard: ASTM F1941/F1941M-2016, Fe/Zn 3AN

